

## Assembly Instructions for PPMX Connector

### Wire Preparation

1. Strip outer jacket off of multi-conductor cable.
2. Strip back all four wires by 0.24 [6.1mm].



### Contact Pin and Socket Fabrication

Crimp contacts and sockets onto wire using a four-indent crimp.

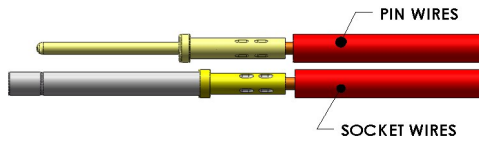

### Contact Pin Installation

Use positions 1 and 2, to install contact pins into the holder.

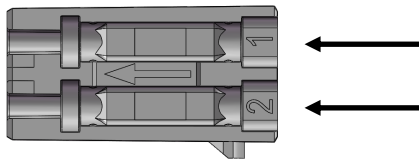

1. Begin installing contacts into the holder.
2. Install pin contacts in first, as shown.
3. Push pins down into slots.

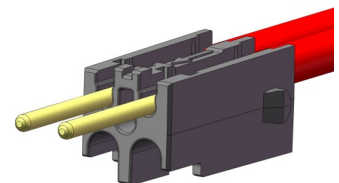
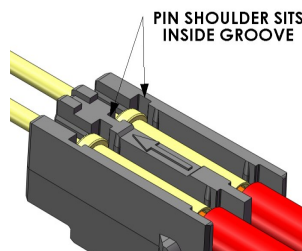
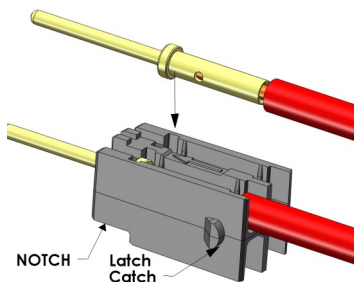

## Socket Installation

Use positions 3 and 4, to install sockets into holder.

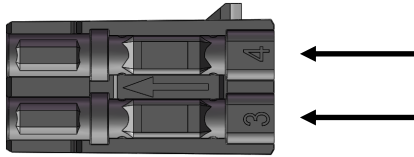

Flip holder over and install socket contacts, as shown. Pin contacts should be retained in the holder.

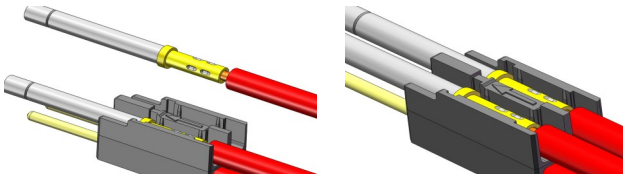

## Loaded Holder Installation

Install loaded holder into the back of the housing as shown.

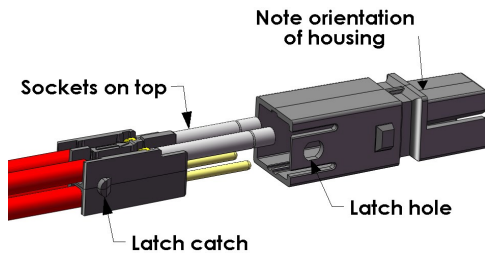

When the holder is fully installed in the housing, a “click” will be felt and heard as the catch locks into the side hole. Give a gentle tug on the wires to confirm that the housing is locked in place. Then insert this PPMX housing into the main housing body, following the Assembly Instructions for that specific line. To remove the signal holder from the housing, using a small flathead screwdriver gently press down the latch to release from the latch hole. Then gently pull on the attached wires to remove the holder from the housing.

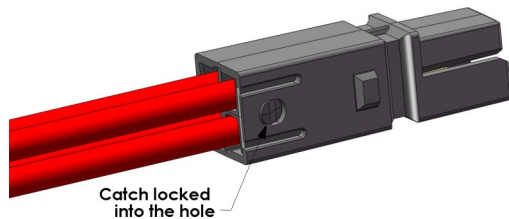

All Data Subject to Change Without Notice 2023-0100 1S6543 Rev 3 **Your Best Connection™**

Anderson™ will use reasonable efforts to include accurate and up-to-date content in the assembly instruction. All product information contained in the instruction sheet including ordering information, illustrations, specifications, and dimensions, are believed to be reliable as of the date of publishing but is subject to change without notice. Anderson™ makes no warranty or representation as to its accuracy. Content in the instruction sheet may contain technical inaccuracies, typographical errors and may be changed or updated without notice. Anderson™ may also make improvements and/or changes to the products and/or to the programs described in the content at any time without notice. Current sales drawings and specifications are available upon request.

©2023 Anderson Power Products, Inc. All rights reserved. Anderson Power Products®, SPEC Pak® and the APP Logo are registered trademarks of Anderson Power Products, Inc. Anderson™ and Your Best Connection™ are trademarks of Anderson Power Products, Inc.



**HEADQUARTERS:** Anderson Power Products®, 13 Pratts Junction Road, Sterling, MA 01564-2305 USA T:+1 978-422-3800 F:+1 978-422-0128 • **EUROPE:** Anderson Power Products® Ltd., Unit 3, Europa Court, Europa Boulevard, Westbrook, Warrington, Cheshire, WA5 7TN United Kingdom T: +44 (0) 1925 428390 F: +44 (0) 1925 520203 • **ASIA / PACIFIC:** IDEAL® Anderson Asia Pacific Ltd., Unit 922-928 Topsail Plaza, 11 On Sum Street, Shatin N.T., Hong Kong T:+(852) 2636 0836 F: +(852) 2635 9036 • **CHINA:** IDEAL® Anderson Technologies (Shenzhen) Ltd., Block A8 Tantou Western Industrial Park, Songgang Baoan District, Shenzhen, PR. China 518105 T: +(86) 755 2768 2118 F: +(86) 755 2768 2218 • **GERMANY:** IDEAL® Industries Germany GmbH, Esslinger Strasse 7, D – 70771 Leinfelden-Echterdingen, T: +49 (0) 711 – 997606666 • **INDIA:** IDEAL® INDUSTRIES India Private Limited, 229-230, SPAZEDGE, Tower B, Sector 47, Sohna Road, Gurgaon – 122018, Haryana, India T: +(91) 956-0075905 T: +(91) 124-4495101 • [www.ideal-industries.in](http://www.ideal-industries.in) • [www.andersonpower.com](http://www.andersonpower.com)