

THE INFORMATION CONTAINED IN THIS DRAWING IS THE SOLE PROPERTY OF ANDERSON POWER PRODUCTS. ANY REPRODUCTION IN PART OR WHOLE WITHOUT THE WRITTEN PERMISSION OF ANDERSON POWER PRODUCTS IS PROHIBITED.

Copyright 2006

ANDERSON POWER PRODUCTS RESERVES THE RIGHT TO ALTER PRODUCT TYPES, THEIR TECHNICAL DATA, DIMENSION, STYLE AND ACCESSORIES WITHOUT PRIOR NOTIFICATION.

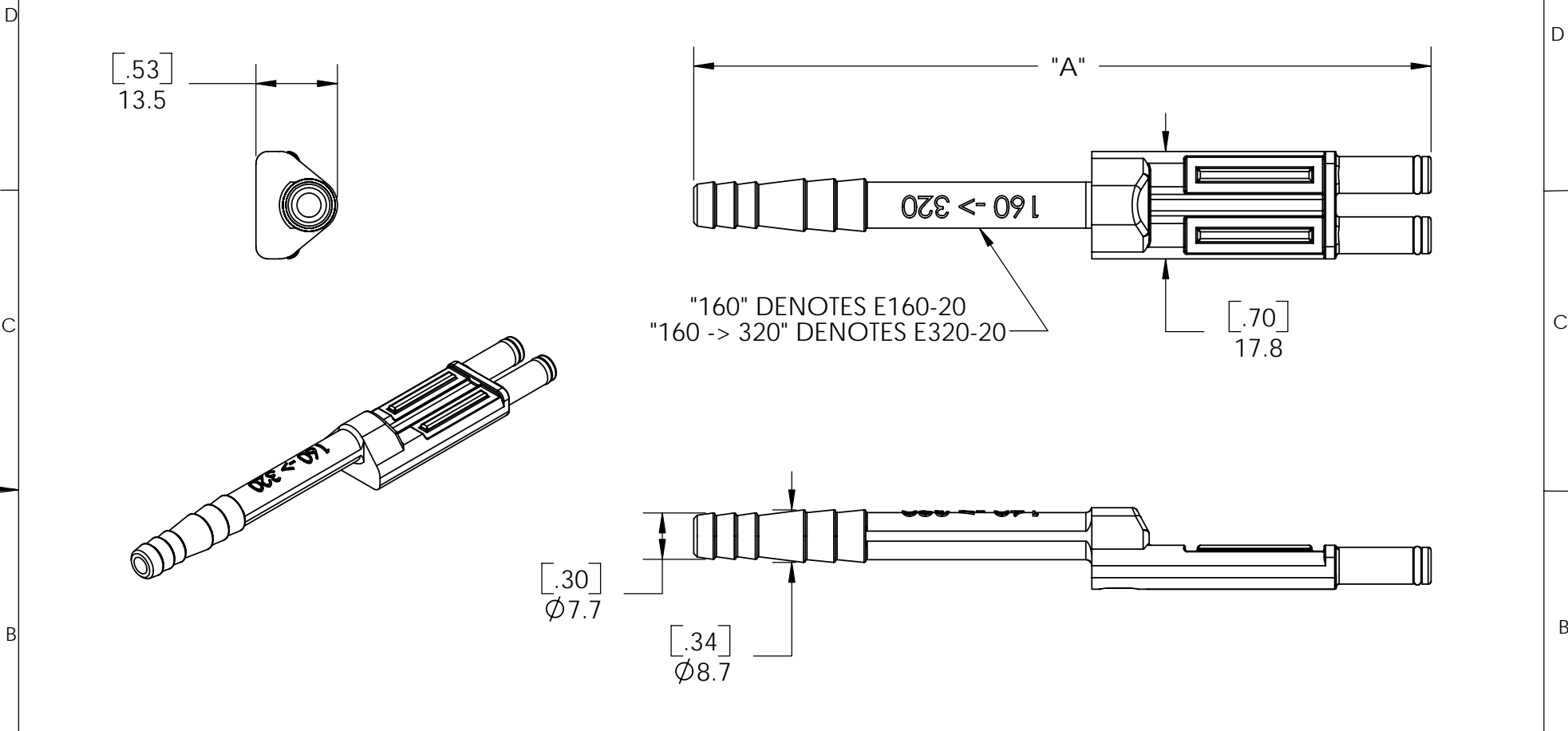

"160" DENOTES E160-20
 "160 -> 320" DENOTES E320-20

| PART NO. | DESCRIPTION | "A" |
|----------|--------------------|-------------|
| E160-20 | 160A MALE AIR TUBE | 106.7[4.20] |
| E320-20 | 320A MALE AIR TUBE | 122.2[4.81] |

| DIMENSIONS ARE IN: | | MM[INCH] | APPROVALS | |
|-------------------------|---------------|----------|----------------|--------------|
| UNLESS OTHERWISE STATED | | | DRAWN | AMS 01/06/06 |
| TOLERANCES: | | | CHECKED | DJD 01/10/06 |
| DECIMALS (INCH) | DECIMALS (MM) | ANGLES | MFG APP | CHB 01/09/06 |
| XX ± .02 | X ± .5 | ± 2° | QC APP | UFN 01/09/06 |
| SURFACE FINISH: | | | ENG APP | DAM 01/06/06 |
| MACHINED | 128 [3.2] | ✓ | | |
| MOLDED | 64 [1.6] | ✓ | | |
| MATERIAL: SEE B/M | | | | |
| FINISH: SEE B/M | | | | |

ANDERSON POWER PRODUCTS

TITLE

SALES OUTLINE
 TWIN AIR TUBE (MALE)
 160A & 320A DIN CONNECTORS

| REV. | DESCRIPTION OF CHANGES | APPROVED | DATE |
|------|-------------------------------|----------|--------|
| 1 | ECRN 13957 - CHANGES PER ISIR | AMS | 2/9/06 |

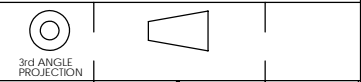

-CAD GENERATED DRAWING-
 DO NOT MANUALLY UPDATE
 DO NOT SCALE

| | | |
|-------|-----------|--------|
| SIZE | DWG NO. | REV. |
| A/A4 | E320-20S1 | 1 |
| SCALE | CADFILE | SHEET |
| NONE | 02489 | 1 OF 1 |