

8

7

6

5

4

3

2

1

THE INFORMATION CONTAINED IN THIS DRAWING IS THE SOLE PROPERTY OF ANDERSON POWER PRODUCTS. ANY REPRODUCTION IN PART OR WHOLE WITHOUT THE WRITTEN PERMISSION OF ANDERSON POWER PRODUCTS IS PROHIBITED.

Copyright 2013

ANDERSON POWER PRODUCTS RESERVES THE RIGHT TO ALTER PRODUCT TYPES, THEIR TECHNICAL DATA, DIMENSION, STYLE AND ACCESSORIES WITHOUT PRIOR NOTIFICATION.

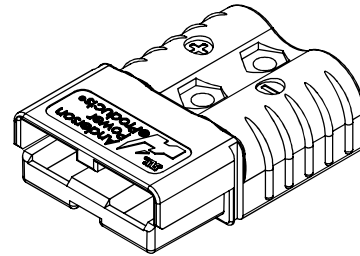
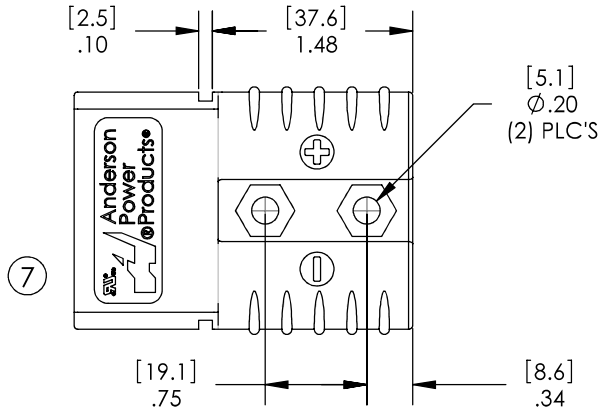

COLOR	P/N	MAT'L
GRAY	6810G1	PC
	P6810G1	PC/PBT
BLUE	6810G2	PC
	P6810G2	PC/PBT
RED	6810G3	PC
	P6810G3	PC/PBT

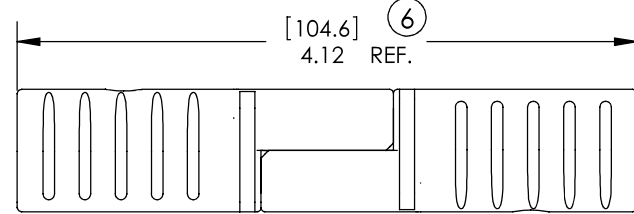
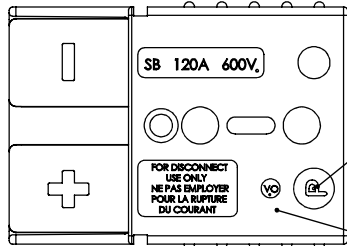
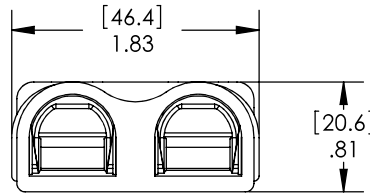
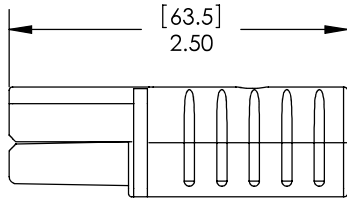

MATED PAIR

DENOTES PBT MATERIAL

SEE NOTE 5

NOTES:

1. SPRING/HOUSING ASSEMBLIES ARE UL RECOGNIZED PER FILE E26226, CSA CERTIFIED PER LR25154
2. HOUSINGS ARE KEYPED TO ONLY ALLOW MATING WITH THE SAME COLOR HOUSING.
3. FOR ASSEMBLY INSTRUCTIONS, SEE DOCUMENT 1S1030A
4. HOUSING ASSEMBLIES ACCOMODATE ANDERSON CONTACTS FOR WIRE RANGES #6 AWG TO #2 AWG.
5. MANUFACTURING AND AGENCY MARKINGS SHOWN ON THIS SURFACE.

DIMENSIONS ARE IN:	INCH [MM]	APPROVALS		ANDERSON POWER PRODUCTS		
UNLESS OTHERWISE STATED		DRAWN	BAL	10/24/2000	TITLE	
TOLERANCES:		CHECKED	DJD	10/24/2000	120A DUAL POLE SPRING AND HOUSING	
DECIMALS (INCH)	DECIMALS (MM)	ANGLES	MFG APPRV	CHB	10/24/2000	
.XX ± .02	.X ± .5	± 2°	QC APPRV	RPO	10/24/2000	
SURFACE FINISH:		ENG APPRV	BAL	10/24/2000	SIZE	DWG NO.
MACHINED 128µin [3.2µ]					A	114283S1
MOLDED 64µin [1.6µ]					SCALE	CADFILE
MATERIAL: SPRINGS-STAINLESS STEEL					NONE	01310
HOUSIN						SHEET
FINISH:						1 OF 2
3rd ANGLE PROJECTION		-CAD GENERATED DRAWING- DO NOT MANUALLY UPDATE DO NOT SCALE				

REV.	DESCRIPTION	APPRV	DATE
7	ECN 2022-0103 - UPDATED APP LOGO PER 113826P6	CPD	9/29/2022
6	ECN 2016-0112 - CHANGED NOTE 7, ADDED REF. TO DIM.	CPD	12/9/2016
5	ECN 2016-0085	CPD	10/20/2016
4	ECRN-14934 COLOR KEYING ADDED	TWE	7/5/11
3	ECRN 14661: "PC/PBT" WAS "PBT"	CMS	7/7/10
REVISIONS			

8

7

6

5

4

3

2

1

8

7

6

5

4

3

2

1

THE INFORMATION CONTAINED IN THIS DRAWING IS THE SOLE PROPERTY OF ANDERSON POWER PRODUCTS. ANY REPRODUCTION IN PART OR WHOLE WITHOUT THE WRITTEN PERMISSION OF ANDERSON POWER PRODUCTS IS PROHIBITED.

Copyright 2013

ANDERSON POWER PRODUCTS RESERVES THE RIGHT TO ALTER PRODUCT TYPES, THEIR TECHNICAL DATA, DIMENSION, STYLE AND ACCESSORIES WITHOUT PRIOR NOTIFICATION.

D

D

C

C

B

B

A

A

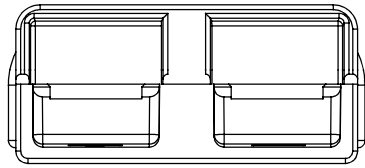

GRAY VOLTAGE KEYING

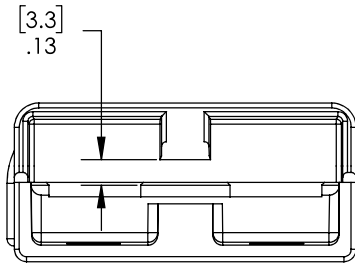

BLUE VOLTAGE KEYING

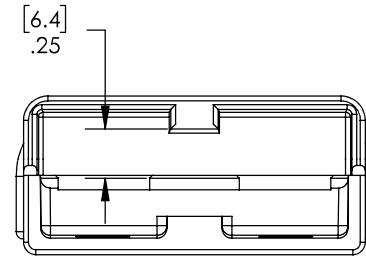

RED VOLTAGE KEYING

DIMENSIONS ARE IN:		INCH [MM]		APPROVALS		ANDERSON POWER PRODUCTS			
UNLESS OTHERWISE STATED		DRAWN		BAL		10/24/2000		TITLE 120A DUAL POLE SPRING AND HOUSING	
TOLERANCES:		CHECKED		DJD		10/24/2000			
DECIMALS (INCH)	DECIMALS (MM)	ANGLES	MFG APPRV		CHB		10/24/2000		
.XX ± .02	.X ± .5	±2°	QC APPRV		RPO		10/24/2000		
SURFACE FINISH:		MACHINED		128µin [3.2µ]		ENG APPRV		SIZE A	
MOLDED		64µin [1.6µ]		FINISH:		BAL			DWG NO. 114283S1
MATERIAL: SPRINGS-STAINLESS STEEL		HOUSIN		DO NOT MANUALLY UPDATE		SCALE		CADFILE 01310	
REV.		DESCRIPTION		APPRV		DATE			SHEET 2 OF 2
-		See Sheet1		-		-			
REVISIONS		3rd ANGLE PROJECTION		-CAD GENERATED DRAWING- DO NOT MANUALLY UPDATE DO NOT SCALE		NONE			

8

7

6

5

4

3

2

1