

THE INFORMATION CONTAINED IN THIS DRAWING IS THE SOLE PROPERTY OF ANDERSON POWER PRODUCTS. ANY REPRODUCTION IN PART OR WHOLE WITHOUT THE WRITTEN PERMISSION OF ANDERSON POWER PRODUCTS IS PROHIBITED.

Copyright 2000

ANDERSON POWER PRODUCTS RESERVES THE RIGHT TO ALTER PRODUCT TYPES, THEIR TECHNICAL DATA, DIMENSION, STYLE AND ACCESSORIES WITHOUT PRIOR NOTIFICATION.

D
C
B
A

D
C
B
A

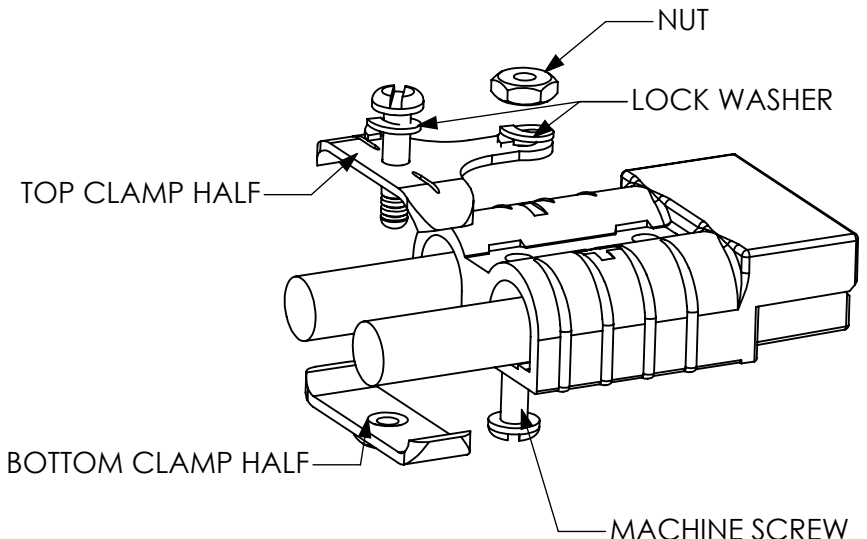
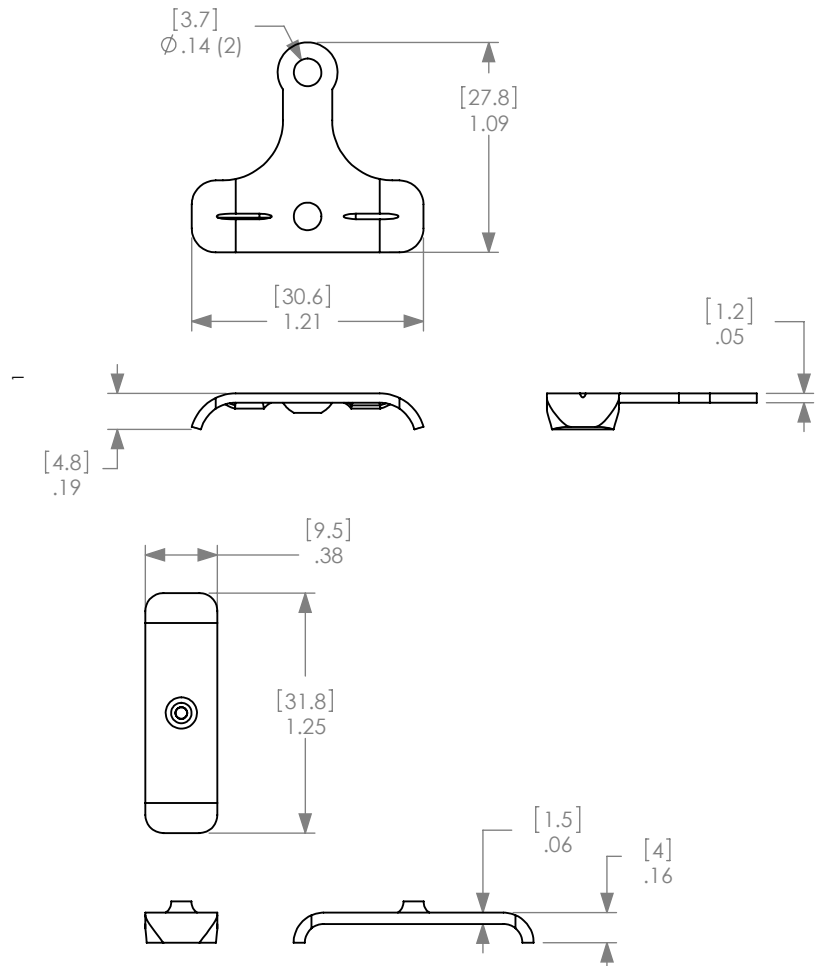

NOTES:

1. MATERIAL: STEEL, ZINC/YELLOW PLATE
2. HARDWARE KIT INCLUDES TWO MACHINE SCREWS, TWO LOCK WASHERS, AND ONE NUT
3. USE WITH SINGLE CONDUCTOR CABLE
4. CONNECTOR SOLD SEPARATELY

DIMENSIONS ARE IN:		INCH [MM]		<i>APPROVALS</i>		ANDERSON POWER PRODUCTS	
UNLESS OTHERWISE STATED				DRAWN	CMS	2/2/2000	
TOLERANCES:				CHECKED	DJD	2/3/2000	
DECIMALS (INCH)	DECIMALS (MM)	ANGLES		MFG APPRV	CHB	7/17/2000	
.XX ± .02	.X ± .5	±2°		QC APPRV	RPO	7/11/2000	
SURFACE FINISH:				ENG APPRV	UFN	7/19/2000	
MACHINED		128µin [3.2µ]		TITLE			
MOLDED		64µin [1.6µ]		CATALOG NUMBER 990G1			
MATERIAL: SEE NOTES				SB50 CABLE CLAMP FOR			
FINISH: SEE NOTES				SINGLE CONDUCTOR CABLE			
3rd ANGLE PROJECTION				SIZE	DWG NO.		REV.
				A	114227S1		2
				SCALE	CADFILE		SHEET
				NONE	01185		1 OF 1

REV.	DESCRIPTION	APPRV	DATE
2	ECRN-15725 CORRECT TYPO TO ONE NUT	TWE	10/7/2014
1	ECRN-14849 CLAMP THICKNESS DIM	TWE	3/8/11
REVISIONS			