

SBS® 50 Cable Clamp Assembly Instructions Components

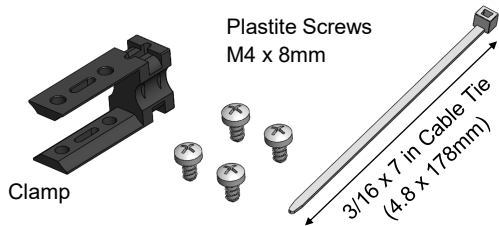

Clamp, Screws, & Cable Tie
Sold as a Kit—B02647GKIT1

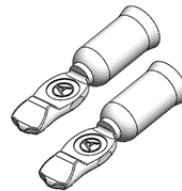

Contacts
Sold Separately

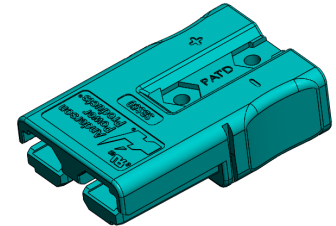

Housing
Sold Separately

Tools You Will Need

- Screwdriver, Philips
- Wire Tie Installation Tool, IDEAL® Part Number 41-990

Instructions

1. Assemble the SBS®50 using APP® assembly instructions 1S6417 and using APP® recommended *crimp tooling. Then follow directions below for Clamp assembly.

*Refer to APP® Crimp Specification 1S6605 for determining how to verify a successful crimp.

2. Insert cables into connector (figure 1).

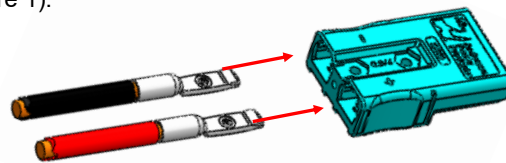

Figure 1

3. Insert Cable Clamp onto housing as shown (figure 2 and 2A).

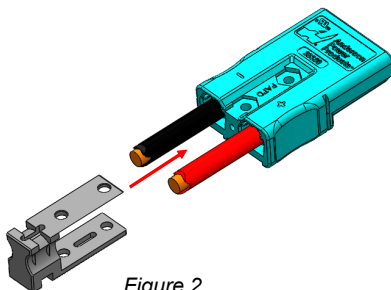

Figure 2

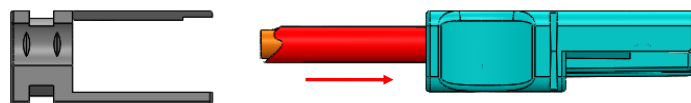

Figure 2A

4. Secure the Cable Clamp to the center position of the housing as shown, using (4) screws. Drive screws snug against clamp's surface. Torque screws 8 to 12 in/lbs (figure 3).

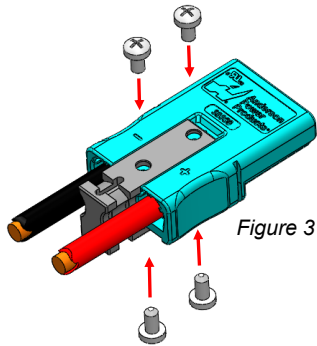

Figure 3

5. Apply the wire tie, wrapping the wire tie around cables and clamp as shown (figure 4). If using the wire tie installation tool, follow installation tool's instructions as shown (figure 5). If tightening by hand, tighten wire tie until fully secure, then cut the excess off as shown (figure 6).

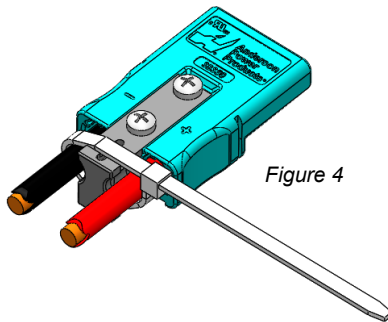

Figure 4

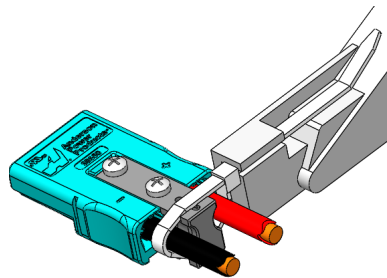

Figure 5

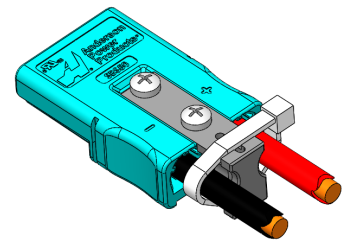

Figure 6

Wire Tie Installation Tool Order Information



IDEAL Industries Inc.



Part Number 41-990

1-800-435-0705

Website https://idealind.com/content/electrical/en_US/wheretobuy.html

All Data Subject To Change Without Notice 2023-0043 1S6825 Rev 2 **Your Best Connection™**

Anderson™ will use reasonable efforts to include accurate and up-to-date content in the assembly instruction. All product information contained in the instruction sheet including ordering information, illustrations, specifications, and dimensions, are believed to be reliable as of the date of publishing, but is subject to change without notice. Anderson™ makes no warranty or representation as to its accuracy. Content in the instruction sheet may contain technical inaccuracies, typographical errors and may be changed or updated without notice. Anderson™ may also make improvements and/or changes to the products and/or to the programs described in the content at any time without notice. Current sales drawings and specifications are available upon request.

© 2023 Anderson Power Products, Inc. All rights reserved. Anderson Power Products®, SBS® and the logo are registered trademarks of Anderson Power Products, Inc. Anderson™ and Your Best Connection™ are trademarks of Anderson Power Products, Inc.



HEADQUARTERS: Anderson Power Products®, 13 Pratts Junction Road, Sterling, MA 01564-2305 USA T:+1 978-422-3600 F:+1 978-422-0128 • **EUROPE:** Anderson Power Products® Ltd., Unit 3, Europa Court, Europa Boulevard, Westbrook, Warrington, Cheshire, WA5 7TN United Kingdom T: +44 (0) 1925 428390 F: +44 (0) 1925 520203 • **ASIA / PACIFIC:** IDEAL® Anderson Asia Pacific Ltd., Unit 922-928 Topsail Plaza, 11 On Sum Street, Shatin N.T., Hong Kong T:+(852) 2636 0836 F:+(852) 2635 9036 • **CHINA:** IDEAL® Anderson Technologies (Shenzhen) Ltd., Block A8 Tantou Western Industrial Park, Songgang Baoan District, Shenzhen, P.R. China 518105 T: +(86) 755 2768 2118 F: +(86) 755 2768 2218 • **GERMANY:** IDEAL® Industries Germany GmbH, Esslinger Strasse 7, D – 70771 Leinfelden-Echterdingen, T: +49 (0) 711 – 997606666 • **INDIA:** IDEAL® INDUSTRIES India Private Limited, 229-230, SPAZEDGE, Tower B, Sector 47, Sohna Road, Gurgaon – 122018, Haryana, India T: +(91) 956 007 5905 www.ideal-industries.in • www.andersonpower.com