

THE INFORMATION CONTAINED IN THIS DRAWING IS THE SOLE PROPERTY OF ANDERSON POWER PRODUCTS. ANY REPRODUCTION IN PART OR WHOLE WITHOUT THE WRITTEN PERMISSION OF ANDERSON POWER PRODUCTS IS PROHIBITED.

**Copyright 2010**

ANDERSON POWER PRODUCTS RESERVES THE RIGHT TO ALTER PRODUCT TYPES, THEIR TECHNICAL DATA, DIMENSION, STYLE AND ACCESSORIES WITHOUT PRIOR NOTIFICATION.

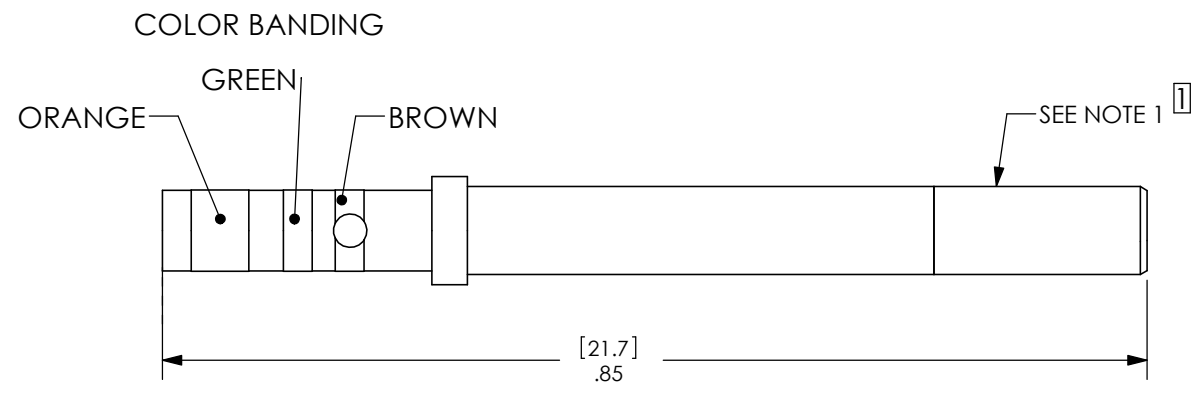

ACTUAL SIZE

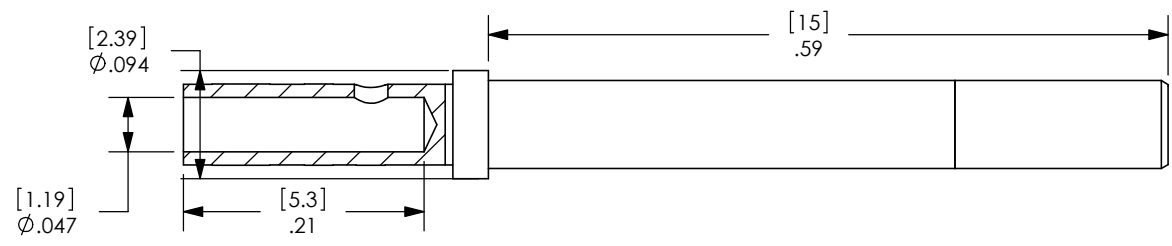
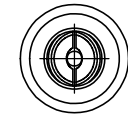
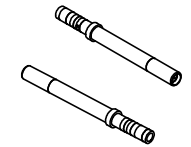

APP P/N: 4802G3-BK

- NOTES:
1. MATERIAL: COPPER ALLOY (MAY INCLUDE STAINLESS STEEL HOOD)
  2. FINISH:  
A. SOCKET INSERT: GOLD PLATE  
B. CONTACT BODY: GOLD OVER NICKEL PLATE
  3. FOR USE AS SIGNAL CONTACT IN SPEC PAK

DIMENSIONS ARE IN: INCH[MM]		APPROVALS		ANDERSON POWER PRODUCTS		
UNLESS OTHERWISE STATED		DRAWN	CMS	12/23/10	TITLE #20-24 AWG CRIMP SOCKET FOR 4-POLE SIGNAL CONNECTOR FOR SPEC PAK	
TOLERANCES:		CHECKED	LLD	12/23/10		
DECIMALS (INCH)	DECIMALS (MM)	ANGLES	MFG APP	CHB		12/23/10
.XX ± .015	X ± .1	±.5°	QC APP	UFN		1/3/11
.XXX ± .005	.XX ± .05		ENG APP	BD	1/3/11	
SURFACE FINISH:		MATERIAL:		SIZE	DWG NO.	
MACHINED 128 [3.2] ✓		SEE NOTES		A/A4	114949S1	
MOLDED 64 [1.6] ✓		FINISH:		SCALE	CADFILE	
SEE NOTES		SEE NOTES		6:1	03364	
3rd ANGLE PROJECTION		-CAD GENERATED DRAWING- DO NOT MANUALLY UPDATE DO NOT SCALE		SHEET	1 OF 1	

1	ECRN 14899	CMS	5/4/11
REV.	DESCRIPTION	APPRV	DATE
REVISIONS			