

THE INFORMATION CONTAINED IN THIS DRAWING IS THE SOLE PROPERTY OF ANDERSON POWER PRODUCTS. ANY REPRODUCTION IN PART OR WHOLE WITHOUT THE WRITTEN PERMISSION OF ANDERSON POWER PRODUCTS IS PROHIBITED.

Copyright 2010

ANDERSON POWER PRODUCTS RESERVES THE RIGHT TO ALTER PRODUCT TYPES, THEIR TECHNICAL DATA, DIMENSION, STYLE AND ACCESSORIES WITHOUT PRIOR NOTIFICATION.

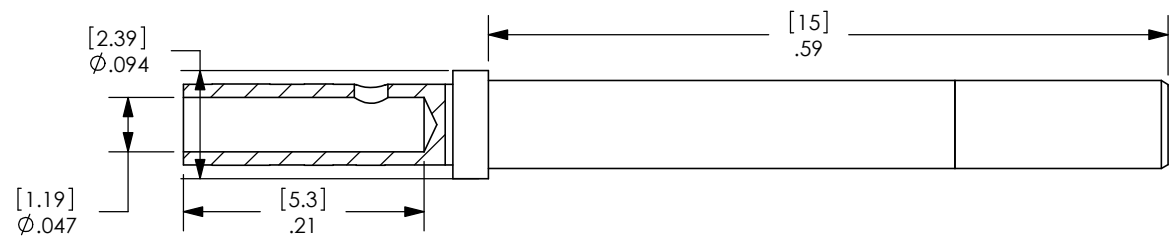
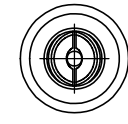
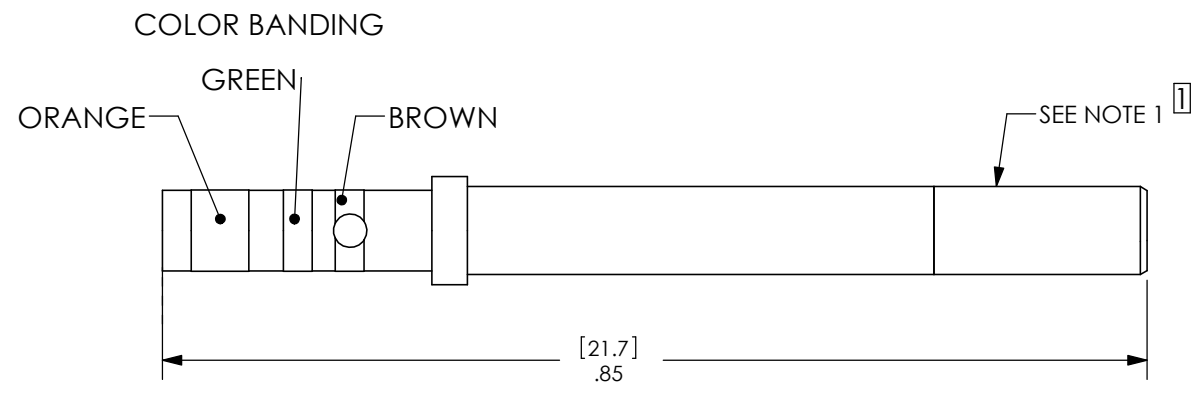

APP P/N: 4802G3-BK

- NOTES:
 1. MATERIAL: COPPER ALLOY (MAY INCLUDE STAINLESS STEEL HOOD)
 2. FINISH:
 A. SOCKET INSERT: GOLD PLATE
 B. CONTACT BODY: GOLD OVER NICKEL PLATE
 3. FOR USE AS SIGNAL CONTACT IN SPEC PAK

| | | | | | | |
|-----------------------------|---------------|---|---------|-------------------------|---|----------|
| DIMENSIONS ARE IN: INCH[MM] | | APPROVALS | | ANDERSON POWER PRODUCTS | | |
| UNLESS OTHERWISE STATED | | DRAWN | CMS | 12/23/10 | TITLE #20-24 AWG CRIMP SOCKET FOR 4-POLE SIGNAL CONNECTOR FOR SPEC PAK | |
| TOLERANCES: | | CHECKED | LLD | 12/23/10 | | |
| DECIMALS (INCH) | DECIMALS (MM) | ANGLES | MFG APP | CHB | | 12/23/10 |
| .XX ± .015 | X ± .1 | ±.5° | QC APP | UFN | | 1/3/11 |
| .XXX ± .005 | .XX ± .05 | | ENG APP | BD | 1/3/11 | |
| SURFACE FINISH: | | MATERIAL: | | SIZE | DWG NO. | |
| MACHINED | 128 [3.2] ✓ | SEE NOTES | | A/A4 | 114949S1 | |
| MOLDED | 64 [1.6] ✓ | FINISH: | | SCALE | REV. | |
| SEE NOTES | | SEE NOTES | | 6:1 | 1 | |
| 3rd ANGLE PROJECTION | | -CAD GENERATED DRAWING- DO NOT MANUALLY UPDATE DO NOT SCALE | | CADFILE | SHEET | |
| | | | | 03364 | 1 OF 1 | |

| | | | |
|-----------|-------------|-------|--------|
| 1 | ECRN 14899 | CMS | 5/4/11 |
| REV. | DESCRIPTION | APPRV | DATE |
| REVISIONS | | | |