

THE INFORMATION CONTAINED IN THIS DRAWING IS THE SOLE PROPERTY OF ANDERSON POWER PRODUCTS. ANY REPRODUCTION IN PART OR WHOLE WITHOUT THE WRITTEN PERMISSION OF ANDERSON POWER PRODUCTS IS PROHIBITED.

Copyright 2006

ANDERSON POWER PRODUCTS RESERVES THE RIGHT TO ALTER PRODUCT TYPES, THEIR TECHNICAL DATA, DIMENSION, STYLE AND ACCESSORIES WITHOUT PRIOR NOTIFICATION.

Part No.	AWG	mm	IN	mm	IN
PM16S2024S32	20/22/24	1.1	.04	2.0	.08
PM16S1620S32	16/18/20	1.7	.07	2.8	.11
PM16S1416S32	14/16	2.1	.08	2.8	.11
PM16S12S32	12	2.6	.10	N/A	N/A

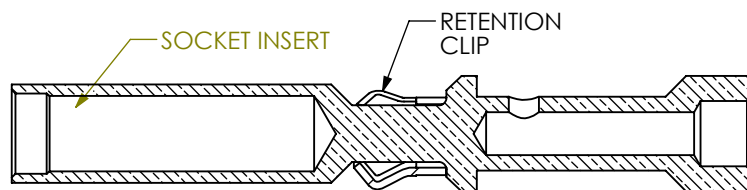
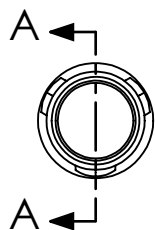
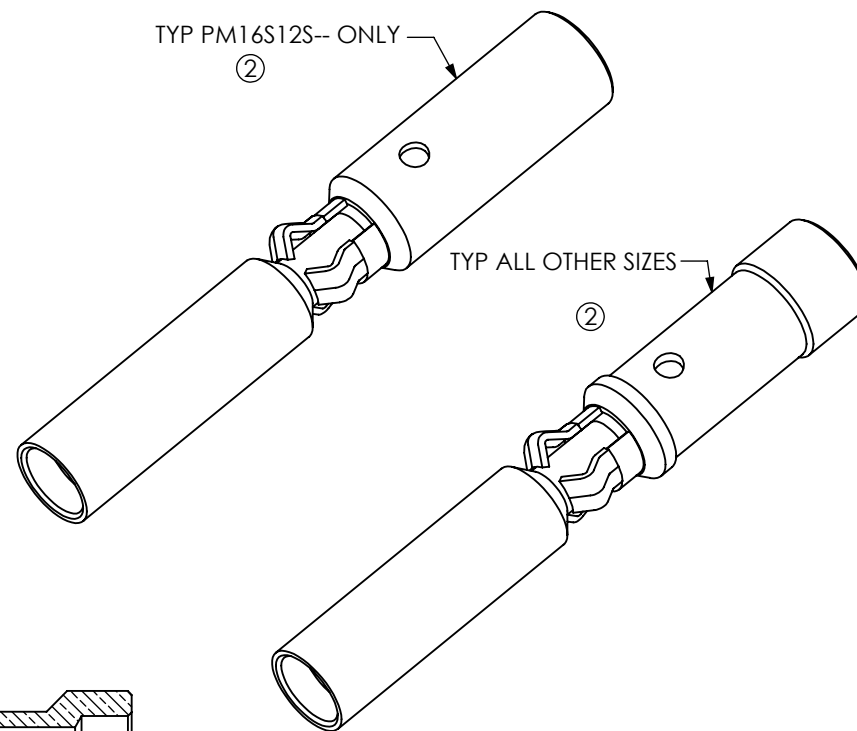

SECTION A-A

NOTES:

1. MATERIAL:

CONTACT BODY: BRASS  
 SOCKET INSERT: BeCu  
 RETENTION CLIP: STAINLESS STEEL

2. FINISH: LEAD FREE

CONTACT BODY- BRIGHT TIN OVER NICKEL  
 SOCKET INSERT- GOLD OVER NICKEL

3. CRIMP CONTACT ONTO WIRE BEFORE INSERTING INTO HOUSING

DIMENSIONS ARE IN:		MM [INCH]	APPROVALS		 <b>ANDERSON POWER PRODUCTS</b>
UNLESS OTHERWISE STATED			<b>DRAWN</b>	CMS	
TOLERANCES:			<b>CHECKED</b>	DJD	1/31/06
DECIMALS (INCH)	DECIMALS (MM)	ANGLES	<b>MFG APP</b>	CHB	2/3/06
.XX ± .02	.X ± .5	± 2°	<b>QC APP</b>	JA	1/30/06
SURFACE FINISH:			<b>ENG APP</b>	UFN	2/3/06
ISO 1302 ✓			<b>SIZE</b>	A/A4	<b>DWG NO.</b>
<b>MATERIAL:</b> SEE NOTES					114646S1
<b>FINISH:</b> SEE NOTES					<b>REV.</b>
					3
			-CAD GENERATED DRAWING- DO NOT MANUALLY UPDATE DO NOT SCALE		<b>SCALE</b>
					NONE
					<b>CADFILE</b>
					02499
					<b>SHEET</b>
					1 OF 1

REV.	DESCRIPTION OF CHANGES	APPROVED	DATE
3	ECRN 15840: REMOVE PART NO'S WITH S30 SUFFIX; REMOVE PLATING COLUMN FROM TABLE; CHANGE NOTE 2 ACCORDINGLY	BCS	7/7/2015
2	ECRN 14485: ADD Ø3.1, ADD ISO VIEW FOR #12 CONTACT	CMS	9/11/09
1	ECRN 14034	CMS	6/19/06