

THE INFORMATION CONTAINED IN THIS DRAWING IS THE SOLE PROPERTY OF ANDERSON POWER PRODUCTS. ANY REPRODUCTION IN PART OR WHOLE WITHOUT THE WRITTEN PERMISSION OF ANDERSON POWER PRODUCTS IS PROHIBITED.

Copyright 2024

ANDERSON POWER PRODUCTS RESERVES THE RIGHT TO ALTER PRODUCT TYPES, THEIR TECHNICAL DATA, DIMENSION, STYLE AND ACCESSORIES WITHOUT PRIOR NOTIFICATION.

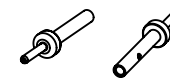

ACTUAL SIZE

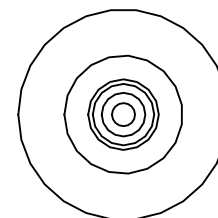
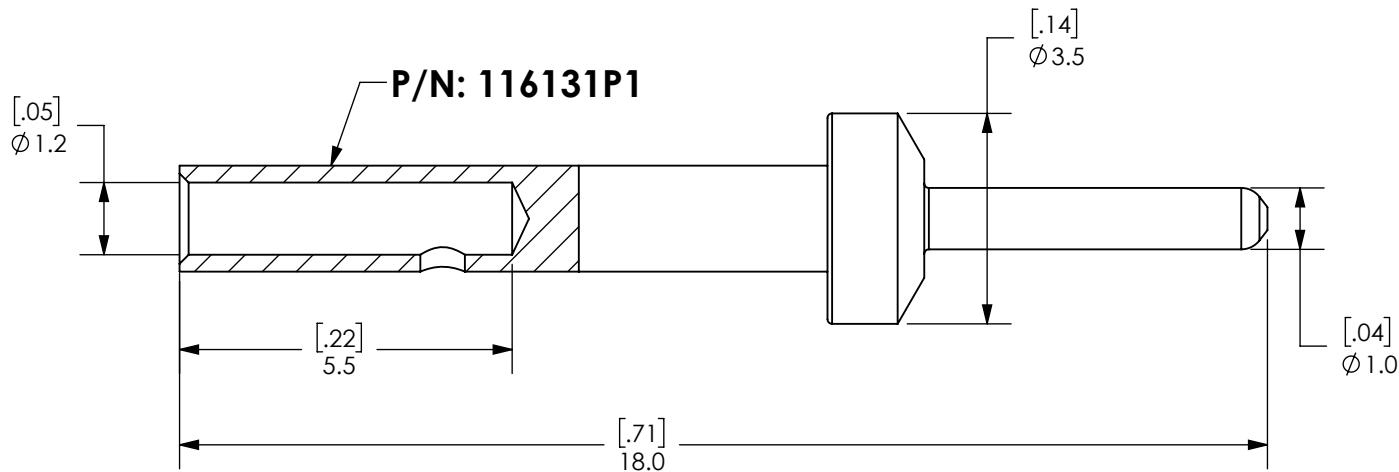

NOTES:

1. MATERIAL: BRASS
2. PLATING: GOLD PLATE
3. TERMINATE CONTACT AFTER WIRE INSERTED THROUGH HOUSING
4. FOR USE IN 6P MINI SPEC PAK® ONLY
5. SOLDER CUP TERMINATION AVAILABLE UPON REQUEST

DIMENSIONS ARE IN:		MM [INCH]		APPROVALS		ANDERSONPOWER™	
UNLESS OTHERWISE STATED							
TOLERANCES:				DRAWN	12/28/2023	TITLE 6P MINI SPEC PAK® #20-24 AWG [0.50-0.25MM ²] PIN	
DECIMALS (INCH)	DECIMALS (MM)	ANGLES		CHECKED	5/14/2024		
.XX ± .02	.X ± .5	±2°		MKT APPRV	5/16/2024	COA	
SURFACE FINISH:				CM		4357	PROD. LINE
MACHINED 3.2µ [128µin] ✓				QC APPRV	5/23/2024	SPEC PAK	
MOLDED 1.6µ [64µin] ✓				MV			
MATERIAL:				ENG APPRV	5/22/2024	SIZE	DWG NO.
*****				SH		A	116200S1
FINISH:				-CAD GENERATED DRAWING- DO NOT MANUALLY UPDATE DO NOT SCALE		SCALE	CADFILE
						NONE	06284
						SHEET	1 OF 1

REV.	DESCRIPTION	APPRV	DATE
REVISIONS			